

THE FACTS, JUST THE FACTS!

- The Democratic Republic of the Congo (DRC) is one of the world's **poorest** countries (GDP/capita: \$704).
- It has the second worst Human Development Index (186 out of 187).
- It has had the **most war-related deaths** (5 million!) since World War II.
- **Abuse of women** has been used routinely as an instrument of war. Around 30% of all women have suffered some form of physical or sexual violence.
- **Women have poorer health** than men; they have shorter life expectancies; they have less access to resources; they have lower literacy rates.
- And many have their ***babies in dirty, unsanitary places*** that lead to infection and death. You don't want to go there!

• WOMEN IN DRC NEED HELP!



Who we are, How to Donate and Where to find more Information

- We are an organization called Friends of IMCK (FIMCK). IMCK, or Institut Médical Chrétien du Kasai in French (Kasai Christian Medical Institute), is the parent medical teaching and treatment complex in the Kasai Province where the city of Kananga is located.



- Our partner in collecting and managing all donations is the Medical Benevolence Foundation, located in Houston, Texas



- Checks can be made out to "FIMCK/MBF" with "IMCK Women's Center/Endowment" written on the memo line. They should be mailed to "Medical Benevolence Foundation/Friends of IMCK", PO Box 96877, Washington, DC 20090.
- Or you can get info & donate on line at <https://www.gofundme.com/congowomenshealthc> or go to www.IMCK.org and click on the orange "Donate to the Endowment" button. This will take you to the MBF donation page where you can make a secure credit card donation. **But be sure to write "IMCK Women's Center/Endowment" in the box labeled "Additional Designation Notes".**
- All donations are tax-deductible.

A WOMEN'S HEALTH CENTER IN THE CONGO (Building it Sustainably!)

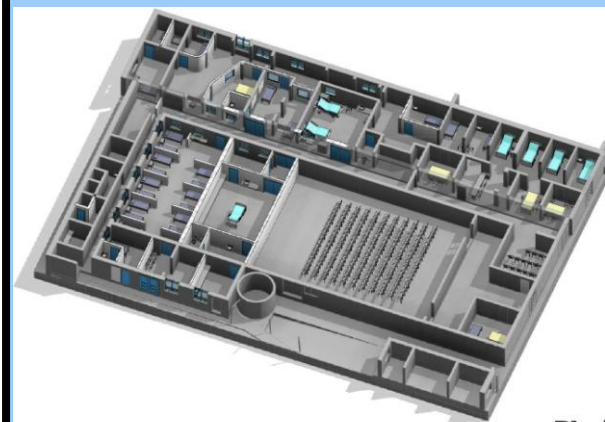

PAX polyc

THE PAX CLINIC for WOMEN

